



It's a great pleasure for us to invite all drivers, mechanics and families to Eskilstuna and the EFRA 1/8 IC Track European Championship

Location: Eskilstuna Motorsportcenter Gröndal Ring
Route guidance: Eskilstuna European route 20 (E20) take exit 129
GPS coordinates: 59.41177, 16.37289

For further information please visit our website: www.mkeskil.se

Airports & Airlines: [LINK](#)
Rental cars: [LINK](#)
Race facility: [LINK](#)
Hotels: [LINK](#)

Our first choice is Clarion Collection Bolinder Munktell (See presentation of the hotel via the link above) where we have blocked 50 rooms, Don't wait too long to make your reservation. When you make your room registration refer to: "MKEskil2016"

Hostels, Bed & Breakfast: [LINK](#)

Camping and cabins: [LINK](#)

Accommodation: Track side camping is possible 100 SEK/night. Toilets and showers are available. Please be nice to book as soon as possible on mail address: tavlingssamordnare@mkeskil.se

Eskilstuna Tourist Service, Rothoffsvillan, Tullgatan 4, +46 16 710 70 00

Currency converter: [LINK](#)

Cash payment at track in €, change will be given in Sek.

Race Officials:	Race Director:	Tyrone Norrman
	EFRA referee:	Frank Mostery (EFRA)
	National referee:	Dallas Mathiesen
	Timekeeping:	Stefan Svensson
	Technical Inspection:	Kai Virkkala & Magnus Hedlund
	Environmentally responsible:	Wolfgang Kienzle
	Track responsible:	Tommy Broman

Contact and info: Patric Henriksson; tavlingssamordnare@mkeskil.se



MK ESKIL
RACE WAY
INDOOR TRACKS



MKE
GRÖNDAL RING
OUTDOOR TRACKS

SVENSK
BILSPORT

Track info: The track and the Arena was built in the summer 2014 when MK Eskil moved from Arena Bredängen to Eskilstuna Motorsportcenter, Gröndal. It is probably one of the largest and fastest race tracks in the world with a possibility to build a number of different layouts.

The longest track layout is 538 meters. The straights and dosed bends are 6,4 meters wide and the reaming part of the track is 4.4 meters wide. The surface is a smooth and well drained tarmac.

Pit area: 100 places under roof. 230v outlets is available for each one. Adapter that fits the outlet is the driver's responsibility to bring.

The electric current in Sweden is 230 volts and 50 hertz. Plugs and sockets are the same as in the continental countries of the European Union.



Food & refreshments: Well assorted cafe on site for breakfast, lunch and dinner. Fast food, Pizza, Restaurants in close range in the city of Eskilstuna.

Banquet: A banquet will be held at Munktel Museum, Friday July 15, it is free for drivers, mechanics and family need to pay a minor fee.

Video from Warm Up 2015: [LINK](#)

Rules: According to EFRA Handbook 2016.

Fuel: Fuel can be bought at the track.

Tires: Control tires according to EFRA rules. **Brand:** Contact (Contact RC Tyres).

Timekeeping: RCM Ultimate, only AMB or other compatible personal transponder.

Time Schedule:	Monday	Controlled practice
	Tuesday	Controlled practice
	Wednesday	Controlled practice Technical inspection Opening ceremony
	Thursday	Timed practice in heats Technical inspection Qualifying round 1-2
	Friday	Qualifying round 3-5 Super pole Sub final128 and 64 Banquet
	Saturday	Rest of the Sub finals. Semi finals Finals Reward ceremony



MK ESKIL
RACE WAY
INDOOR TRACKS



MKE
GRÖNDAL RING
OUTDOOR TRACKS

SVENSK
BILSPORT

OVERVIEW OF THE RACE FACILITIES

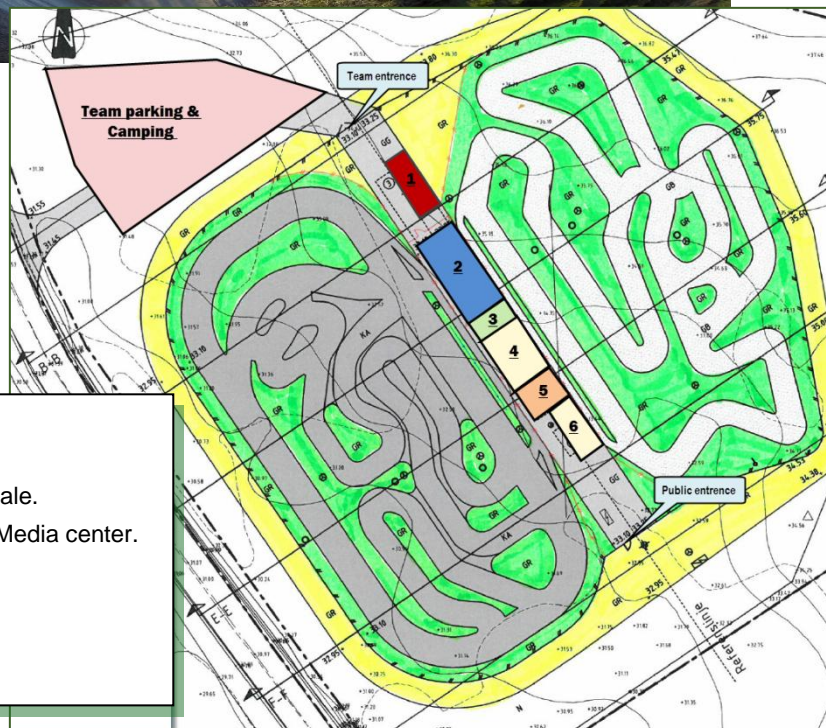

- 1: Compressed air for cleaning.
- 2: Mechanic-area for race teams under roof.
- 3: Technical inspection, Registration and Tire sale.
- 4: Upper deck: Drivers stand, Race controller, Media center.
Floor level: Pit area and Tire true area.
- 5: Upper deck: Race directory and back office
Ground floor: Catering and handicap toilet.
- 6: Toilet and shower building.

SPONSORS



MK ESKIL
RACE WAY
INDOOR TRACKS



MKE
GRÖNDAL RING
OUTDOOR TRACKS

SVENSK
BILSPORT